

# Model 89401 Self-Leveling Wide Mouth Thru-Wall Skimmer

## INSTALLATION INSTRUCTIONS

1. If pool wall **IS** factory pre-cut for a skimmer and return fitting follow these instructions, otherwise go to **step 2** below.
  - a. Locate the wall opening, and punch out the (22) twenty two 1/4" holes, and rectangular cut out.
  - b. Find the pre-cut area for the return fitting and knock out the cut out.
  - c. With a file or piece of sandpaper remove any metal burrs that may cut the liner or yourself during the assembly.
  - d. Skip step 3 and go directly to step 4.
2. If the pool wall is **NOT** factory pre-cut for a skimmer and return follow these instructions.
  - a. Using the **Hole Template Guide**, locate the area against the metal wall at your desired position. (The water level should be approximately at the mid point of the face plate.) Be careful that the skimmer body and face plate will not interfere with the top coping or the lip of the pool structure.
  - b. Using the **Hole Template Guide** drawing for spacing details, drill (22) 1/4" holes. With a pair of tin snips cut a 5-5/8" x 12" opening in the wall, again using the drawing as a guide.
  - c. Next, find a desired location for the return fitting. The cutout should be approximately 8" below the desired water level. Cut a 2-3/8" diameter circle at the location.
  - d. With a file or piece of sandpaper remove any metal burrs that may cut the liner or yourself during assembly.
3. Install vinyl liner
  - a. Install the vinyl liner according to the swimming pool manufacturer's instructions. **Do not cut any holes in the liner at this time.** Fill the pool to approximately 2" below the return fitting before proceeding to the next steps. Adjust the liner as necessary as pool is filling.
4. Skimmer Housing Installation procedure:
  - a. Select one of the 8905 hose adapters and screw into the bottom of the skimmer housing using the Teflon tape. **Caution**, these are pipe threads and over tightening can crack the housing. **Never use any type of glue or sealant on these threads.**
  - b. From the outside of the pool install the butterfly gasket 89383 into knockout opening in the wall.
  - c. Align the skimmer body/housing and butterfly gasket 89383 with the drilled holes in the

- wall panel and fasten with (4) four pan head screws. These are the 4 short screws in the hardware set. The holes are located on the top and bottom of the housing. They are the 3rd hole in from each side of the housing. (This step is optional per installers preference)
- d. Reach over the top rail of the pool and carefully press the face-plate and liner against the gasket and skimmer cut out in the wall.
  - e. Punch out the two top corner holes using a blunt object. Insert two self-threading screws into the top corner holes of the face-plate
  - f. Carefully push the screws through the holes that have been pierced in the liner and through the double gasket. From the outside of the pool, align the skimmer body with these screws (if step 'c.' was passed over). Lightly tighten the two screws.
  - g. Using a blunt object, pierce the remaining holes in the liner. Insert and lightly tighten the remaining phillips head screws through the face-plate, liner, gasket and into the corresponding holes on the skimmer. Firmly tighten all screws evenly, alternately left and right, top and bottom.
  - h. Using the skimmer face as a guide, use a razor knife to trim only the liner, **being careful not to cut the gasket**, in the large skimmer opening

**5. Return Fitting Installation Procedure:**

- a. Gently press the vinyl liner at the circular wall-fitting opening to locate the exact position. Make a circular cutout in the vinyl approximately 3/4" smaller than the opening in the wall.
- b. Disassemble the 8949 return fitting.
- c. Screw the remaining 8905 hose adapter into the return fitting opposite of the flange end. Use the Teflon tape for a sealant.  
**Use caution not to over tighten as it may crack the fitting. Never use any type of glue or sealant on the pipe threads.**
- d. Place one of the rubber gaskets, from the 3 pc gasket set, on the fitting and insert through the vinyl liner and wall panel. The eyeball side should be inside the pool. Next, place the cork gaskets followed by the rubber gasket over the rear of the fitting and screw the locknut hub up tightly.
- e. Screw the adjustable directional ball fitting into the flange side of the fitting. Direct the flow of water away from the skimmer opening.
- f. Connect the return hose to the pressure side of your filtration system. Secure with a hose clamp.

## **Operating Instructions**

- 1.** To adjust the inlet flow direction loosen the knurled outer ring of the "eyeball" portion and move the ball to the desired position.
- 2.** To clean the 89428-skimmer basket, open the 89427 top cover; and remove the basket. It is recommended that the pool pump be shut off.
- 3.** To vacuum the pool follow these directions:
  - a.** Open the top cover and connect vac hose to the 8905 Hose Adapter on the 89429 Vac Plate. It is not necessary to remove the 89388 basket.
  - b.** Fill your vacuum hose with water by temporarily inserting the hose cuff into the return fitting while the pool pump is on. Make sure all the air is removed from the hose.
  - c.** Try to keep the hose cuff submerged during this process so no air gets back into the hose to cause the pump to cavitate and lose its prime.

## **Winterizing Procedure**

Drain pool level approximately 2" to 4" below skimmer opening. Remove the "eyeball" fitting in return and securely plug wall fitting with 1-1/2" plugs from your dealer. Disconnect filter hoses from the skimmer and wall fitting. Be sure that the skimmer is kept free from water accumulation. Your warranty does not cover damages caused by the formation of ice in the skimmer housing.

## **Parts List**

### **Model 89401 Self-Leveling Wide Mouth Thru-Wall Skimmer System includes:**

89401 Skimmer Body  
89418 Front Plate Cover  
89383 Butterfly Gasket  
89427 Locking Top Plate  
89429 Vac Adapter Top Plate with 8905 Hose Adapter  
89428 Skimmer Basket  
89426 Flap Weir  
8949 Return Fitting including "Eyeball" and Gaskets  
(2) 8905 Hose Adapters (Fit both 1-1/4" and 1-1/2" Hose)  
Stainless Steel Phillips Screw Set 18 Pcs.- #10 x 1" Phillips head  
and 4 pcs #10 x 5/8" short pan heads)  
8948 Roll Teflon Tape



## 89401 Wide-Mouth Water Leveling Through-Wall Skimmer Exploded View

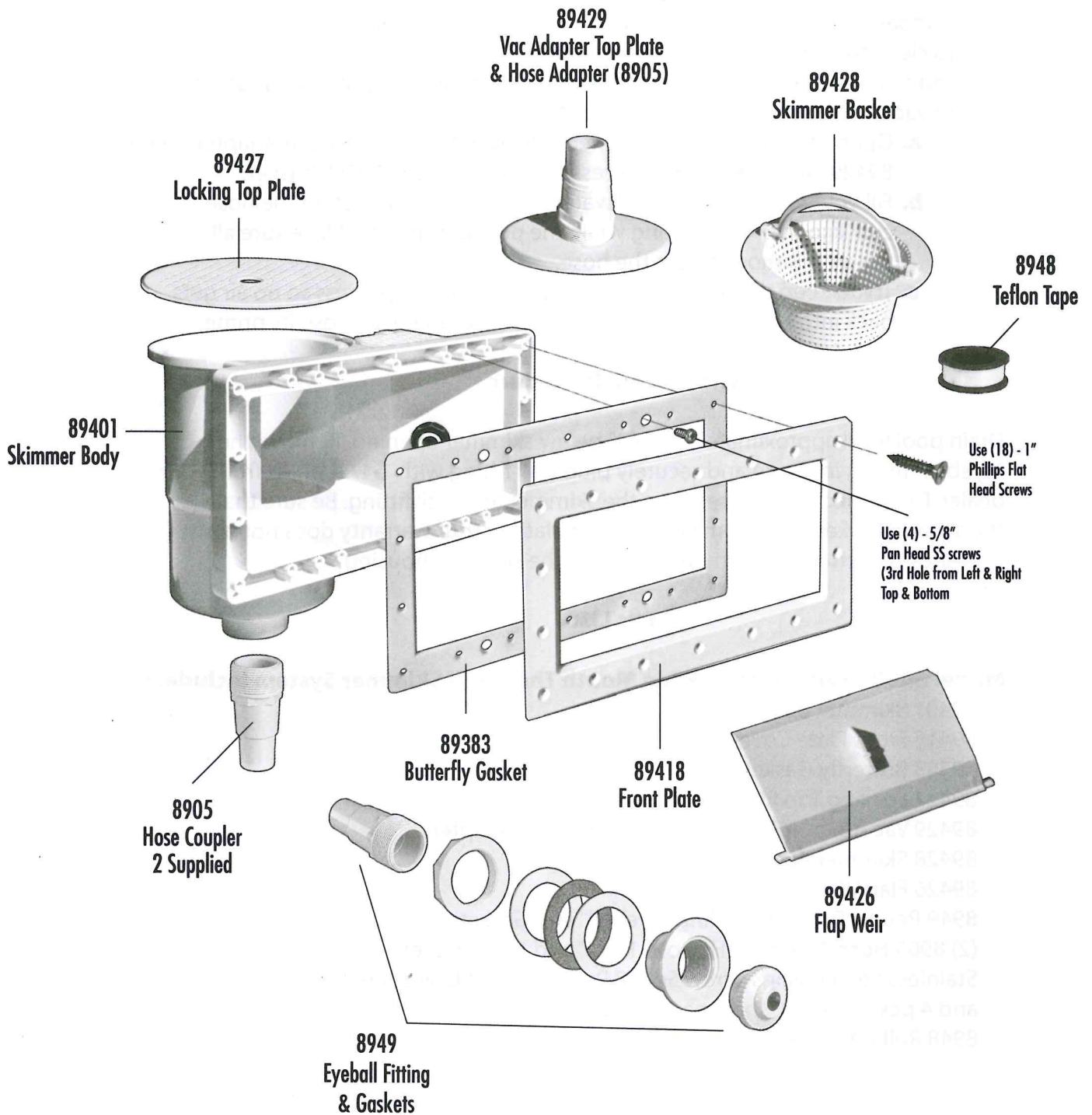

**Instructions  
For 89401  
Widemouth Through-Wall Skimmer  
Automatic Water Leveling Feature**

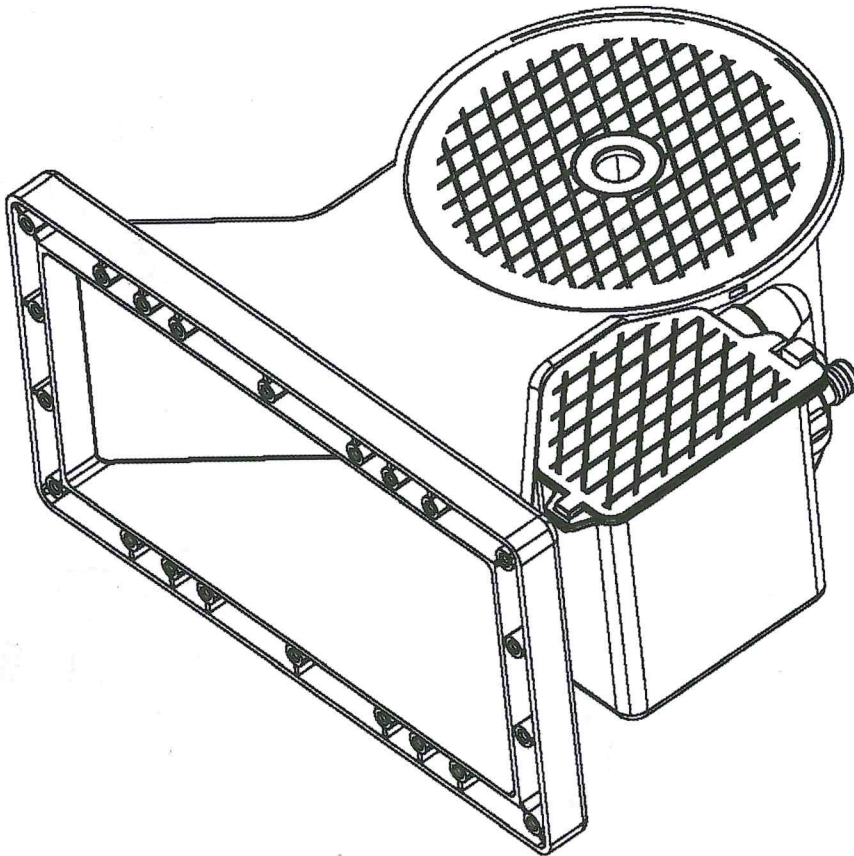

**Please read all directions thoroughly**

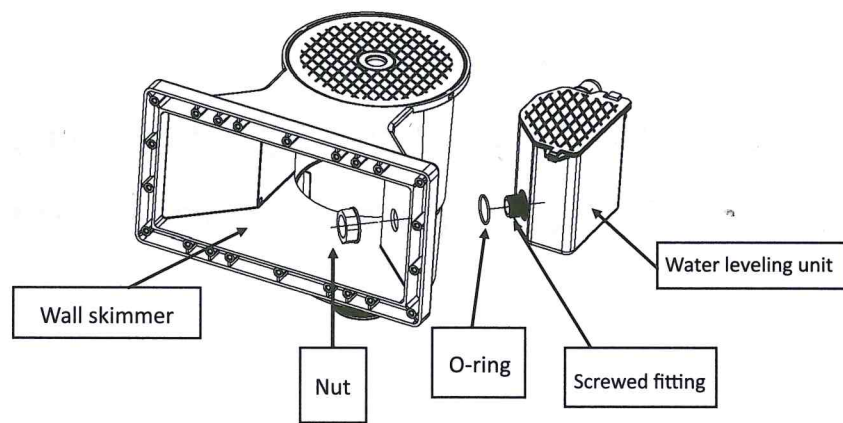

Water leveling unit comes pre-installed.

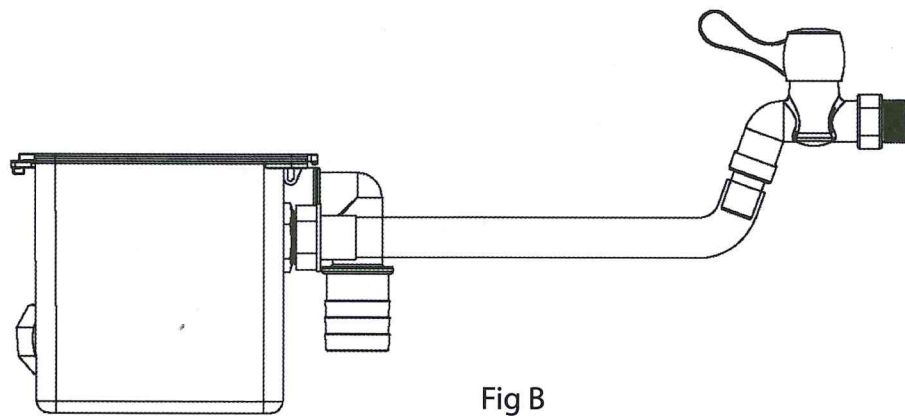
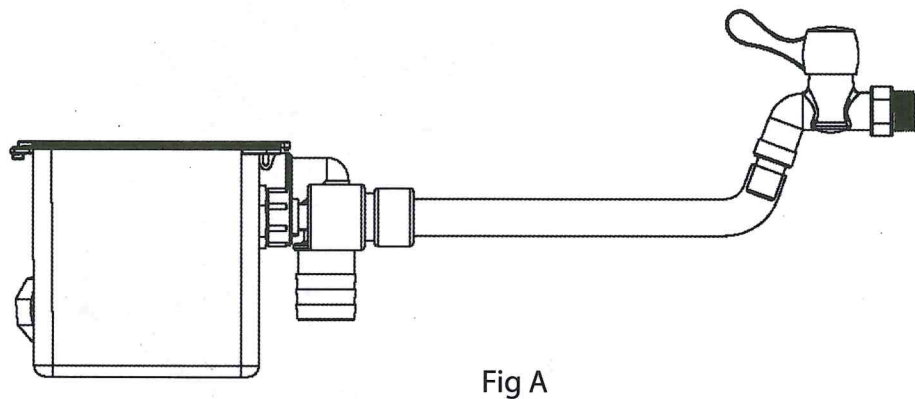

1. The Water Leveling Skimmer requires a water supply hook-up.  
There are two ways to connect the water leveling unit to a water supply:
  - a. Connect water leveling unit to a hose with a quick-connect adaptor (Not included), See Fig A.
  - b. Connect water leveling unit with a standard garden hose, See Fig B.

2. There is an overflow fitting on the water leveling unit so that the water can flow out when the water level of the swimming pool is too high. There are two ways to connect the overflow.
  - a. Use a 1" outer diameter PVC pipe (Not included) to connect to overflow fitting. 1" pipe fits **INSIDE** overflow fitting. See Fig C. (A press fit is usually sufficient to secure)
  - b. Use a 1 1/4" inner diameter pool hose (Not included) to connect to overflow fitting. 1-1/4" hose fits **OUTSIDE** overflow fitting. See Fig D. A standard hose clamp is suggested to secure (Not included).

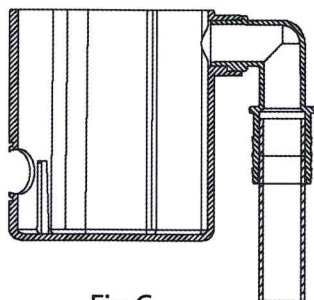

Fig C

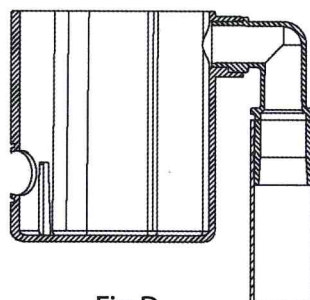
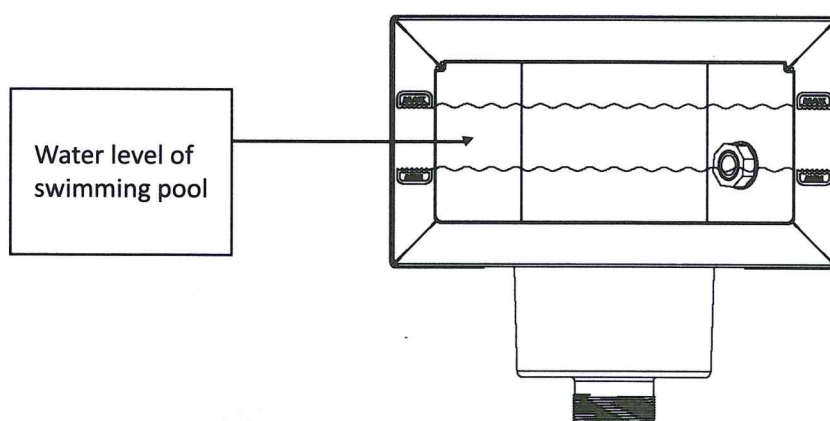
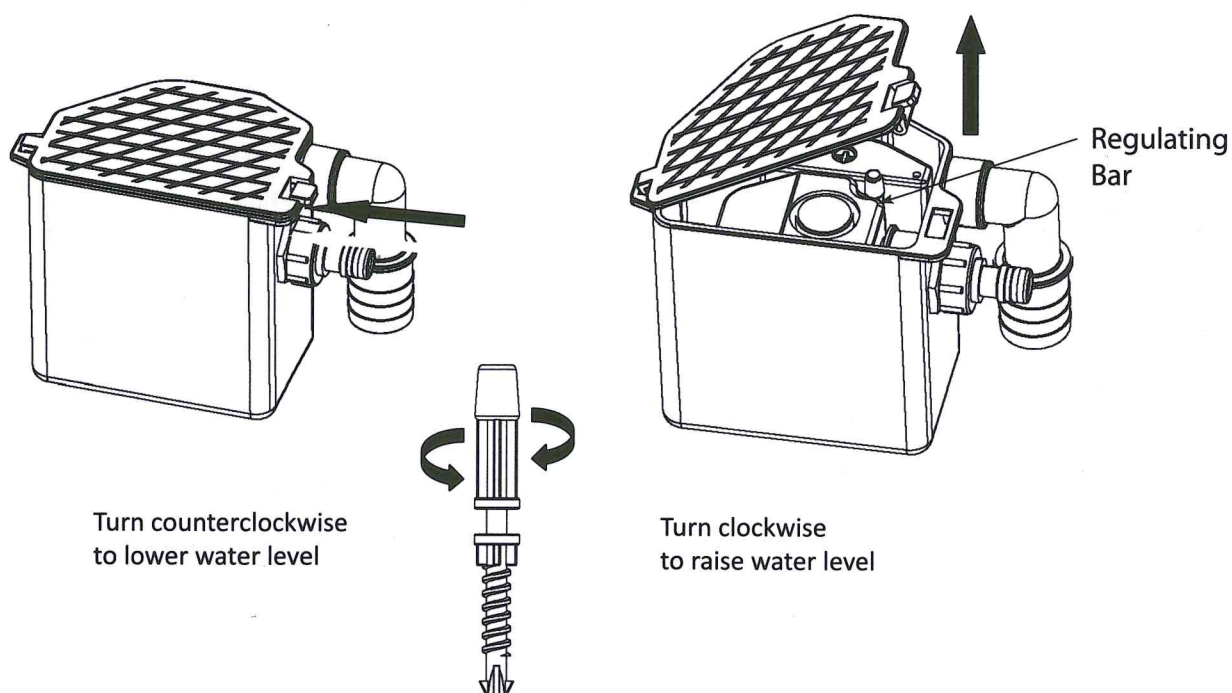

Fig D



3. If you would like to adjust water level of the pool use the regulating bar in the water leveling unit to adjust the level.
  - a. Open the water leveling tank cover and adjust the regulating bar to your desired water level.





**Notes:**

1. Components should not be assembled and disassembled frequently.
  - a. This may cause leakage.
2. Make sure the cover of water leveling unit is properly closed to prevent leaves or other debris from getting into the water leveling unit. Debris will effect float switch functionality and potentially block the outlet. Any debris found should be cleared immediately.
3. To avoid unnecessary damage, do not loosen the quick-connect adaptor or pull hose out when water is running.
4. If the hose connection joint on the leveling unit is leaking, the inlet connector may need to be tightened. (See Part Numbers 14 & 15 below)

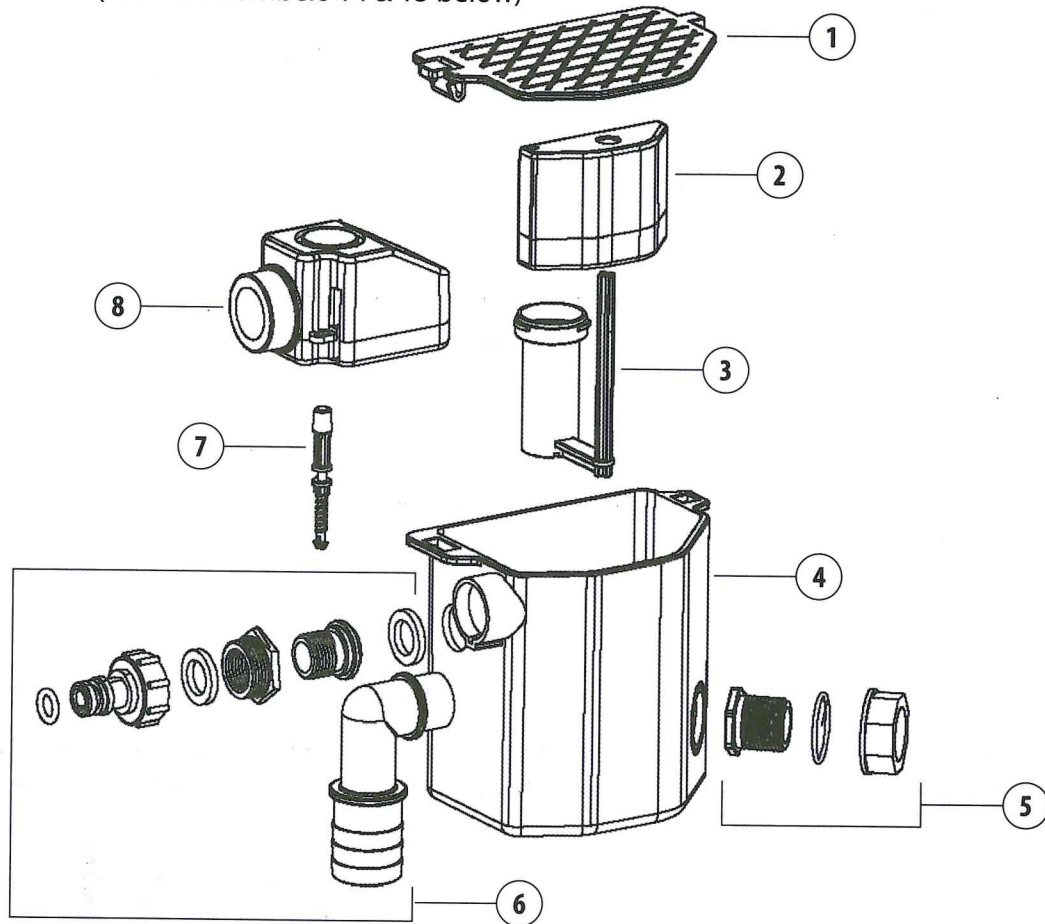

| NO. | PART NUMBER  | DESCRIPTION                                   |
|-----|--------------|---|
| 1   | 89402COV     | Water Tank Cover                              |
| 2   | 89402FLOAT   | Float   |
| 3   | 89402G&P     | Guide Bar & Connecting Pipe                   |
| 4   | 89402TANK    | Water Tank                                    |
| 5   | 89402CONHDWE | Skimmer Body Connection Hardware              |
| 6   | 89402IN&OUT  | Water Inlet and Over-Flow Connection Hardware |
| 7   | 89402REG     | Regulating Bar                                |
| 8   | 89402VALVE   | Valve   |



**TOP**

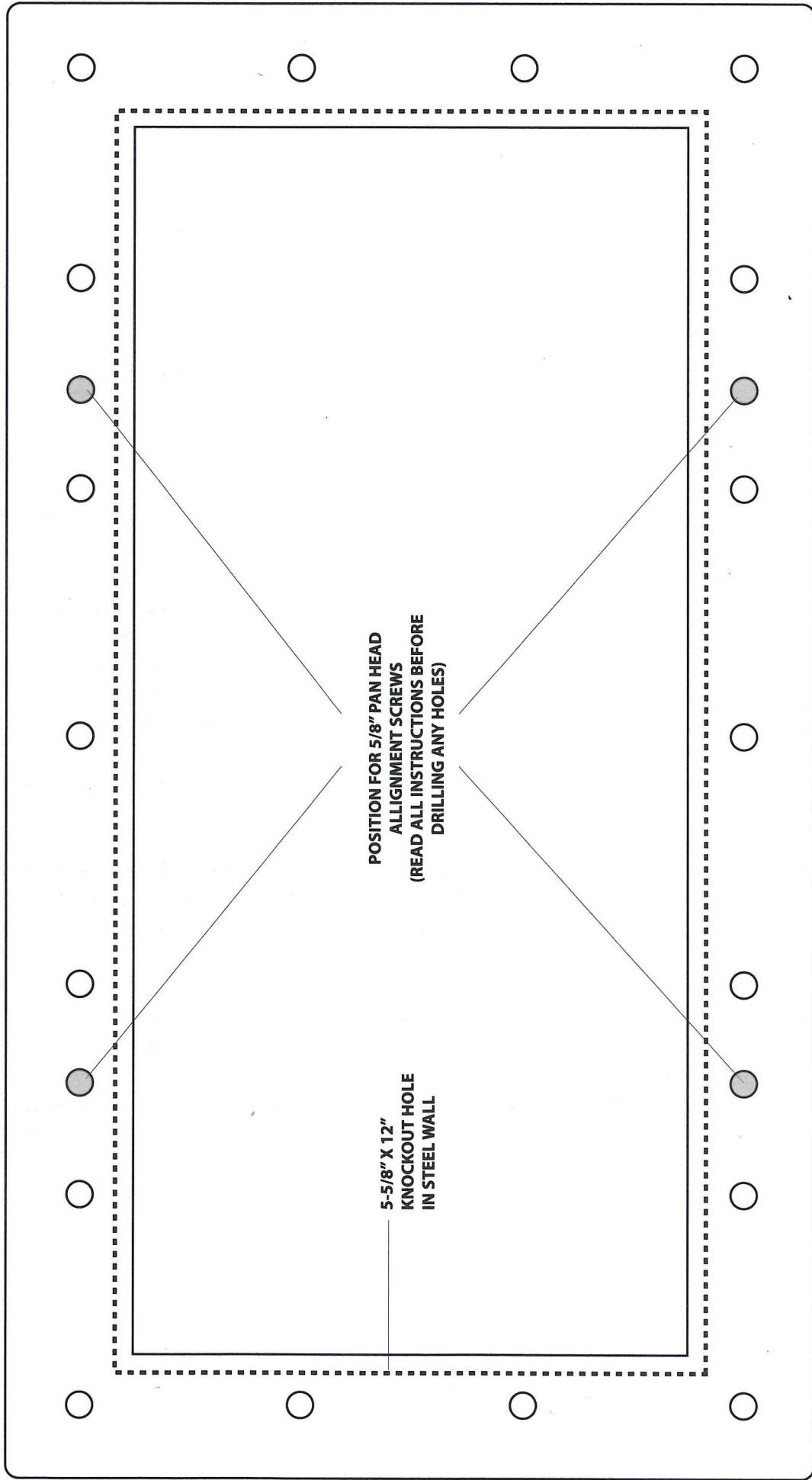

## **HOLE TEMPLATE GUIDE**

**Instrucciones para 89401**  
**Recolector de boca ancha empotrado**  
**en la pared**  
**con característica**  
**de nivelación de agua automática**

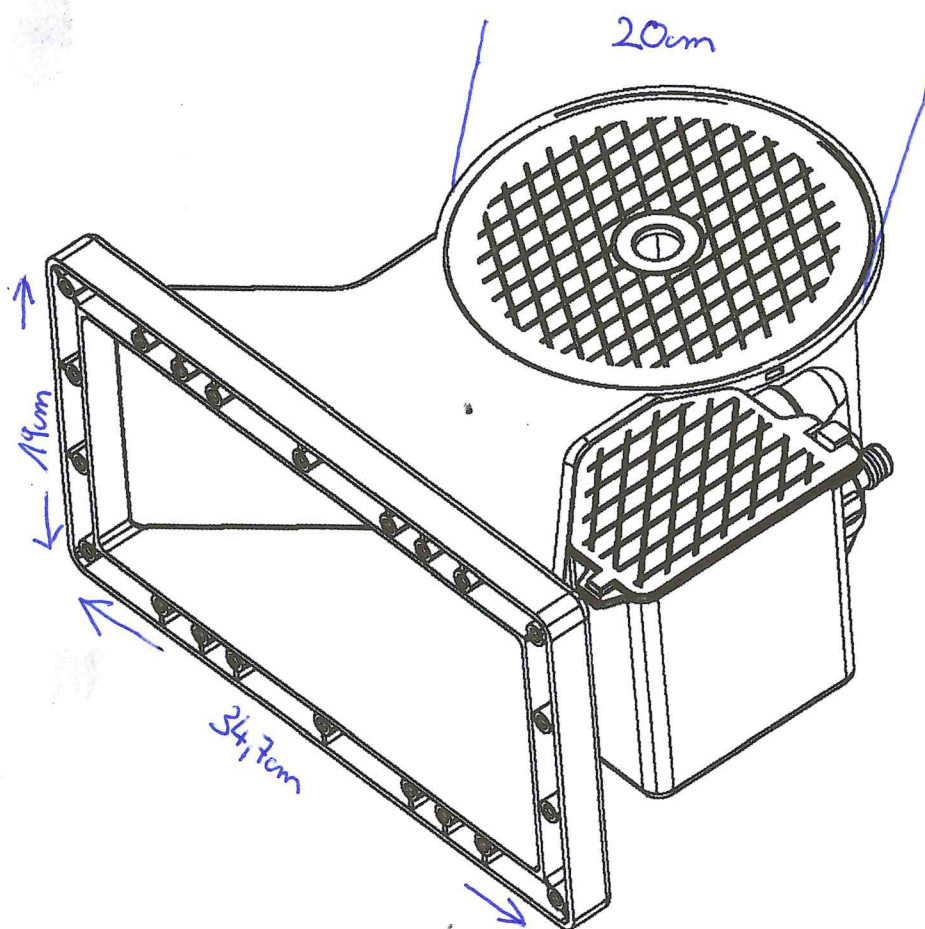

Lea todas las instrucciones minuciosamente